



£198,000

Highfields Close, Shepshed LE12 9SW

Semi-Detached House | 2 Bedrooms | 1 Bathroom

01509 270 010

FROBISHERS

www.frobishers.net



Step Inside

Key Features

- NO UPWARD CHAIN
- Semi Detached House
- NEW WORCESTER BOILER
- Two Double Bedrooms
- Family Bathroom
- New radiators Central Heating
- New Upvc Windows and Doors
- Enclosed Garden
- Off Road Parking

Main Particulars

***** NO UPWARD CHAIN *****

This two bedroom semi-detached property is situated in a quiet close on Highfields Close, Shepshed.

The property can be entered via front door into porch, great for coats and shoes before entering the main house. The lounge is good in size with an electric working fire. Open tread staircase leads to the first floor.

Following through to the kitchen dinner with views on to the garden.

Fitted Kitchen with Single Beko Oven, 4 Burner Gas Hob and extractor fan. A single bowl Stainless Steel sink, plumbing and electrics for washing machine. Tiled splash back and grey board effect floor covering.

First floor offers two double bedrooms, second bedroom has an over the stair cupboard, great for storage.

Bathroom has white sanitary ware and wall tiles. Thermostatic shower over bath with a glass shower screen. Chrome Heated Towel Rail and tiled flooring.

This property benefits from gas central heating, new Worcester boiler and radiator fitted throughout, 6 months ago.

The garden offers grass and hard standing, enclosed by fencing and gate leading to driveway big enough for two cars.

Please call the office on 01509 270010 to avoid disappointment





Ground Floor

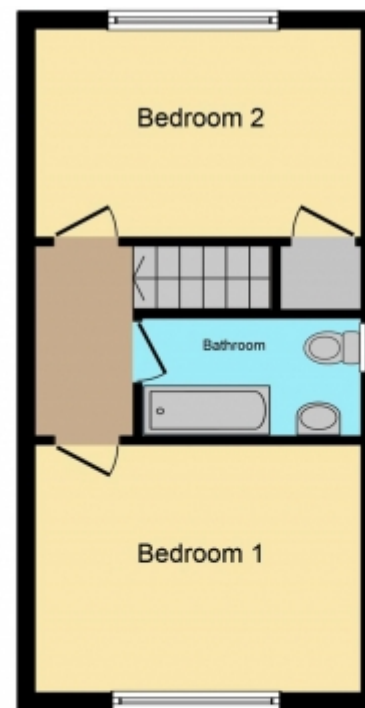

First Floor

Whilst every attempt has been made to ensure the accuracy of this floor plan, all measurements are approximate and no responsibility is taken for any error, omission or misstatement. This plan is for illustration purposes only and may not be representative of the property. Plan not to scale. Specifically no guarantee is given on the total square footage of the property if shown on this plan. Any figure given is for initial guidance only and should not be relied on as a basis of valuation.

Telephone: 01509 270 010



www.frobishers.net