



£220,000 Guide Price

Charnwood Road, Shepshed LE12 9NP

Semi-Detached House | 3 Bedrooms | 1 Bathroom

01509 270 010

FROBISHERS

www.frobishers.net



Step Inside

Key Features

- NO UPWARD CHAIN
- Semi Detached Property
- Three bedrooms
- Dining Room
- Separate Lounge
- Low Maintenance Garden
- Off Road Parking

Main Particulars

NO UPWARD CHAIN -

This three bedroom semi detached house is the perfect home for first time buyers, down sizing or young families. Situated on a connecting road to local transport and close to the M1

A well-presented 3 bedroom semi detached house briefly comprises of an entrance hall, lounge with bay window, rear kitchen, dining room with garden access. Three bedrooms and a family bathroom on the first floor.

Externally there is off road parking on a hard standing drive at the front of the property and a low maintenance private enclosed garden to the rear which can be accessed via a side gate.

EPC to follow

The property is to be sold with no upward chain, please call 01509 270010 phone line is open 7 days a week.



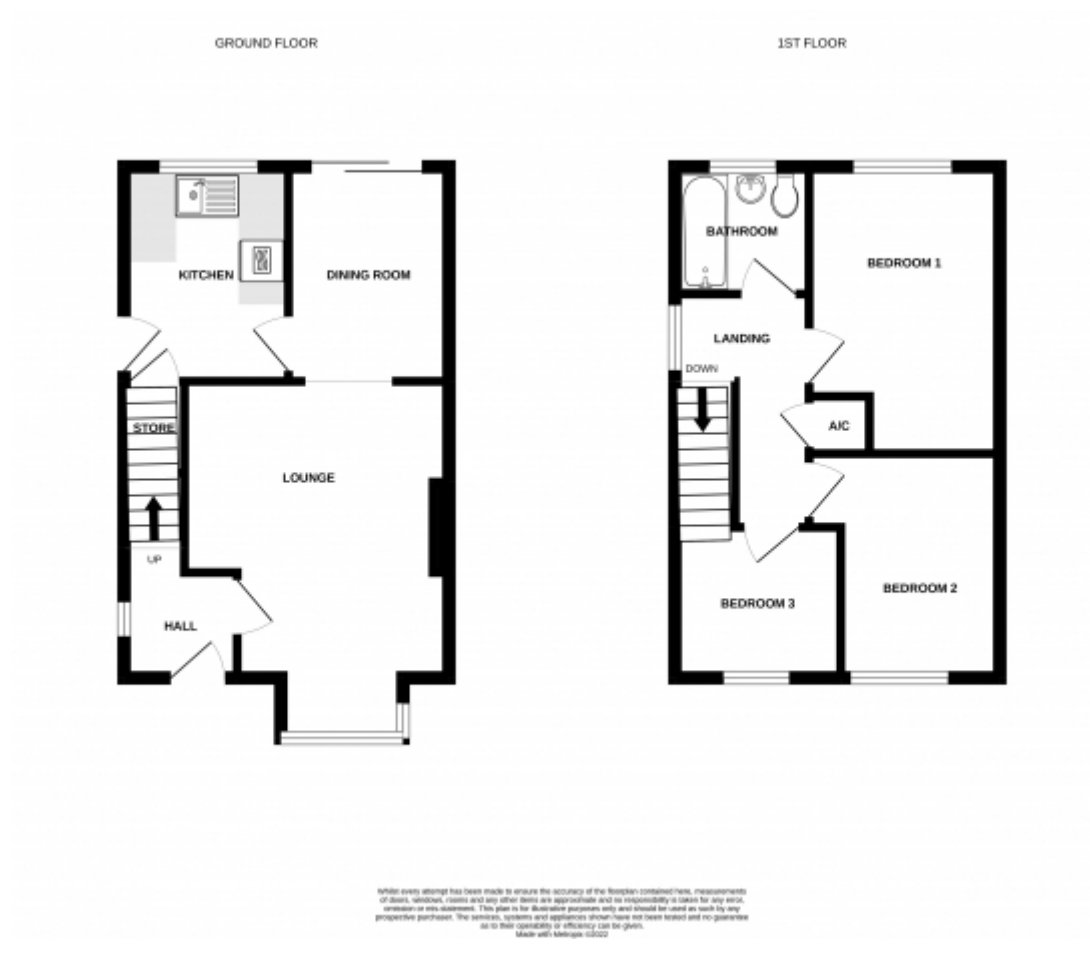

This floorplan is for illustrative purposes only and the location of doors, windows and other items are approximate.

Telephone: 01509 270 010



www.frobishers.net